

REVISIONS					
REV	ECO	DESCRIPTION	DATE	BY	APPR
B1	-	RELEASED DRAWING	JULU-9-2015	ARROW	TOMMY

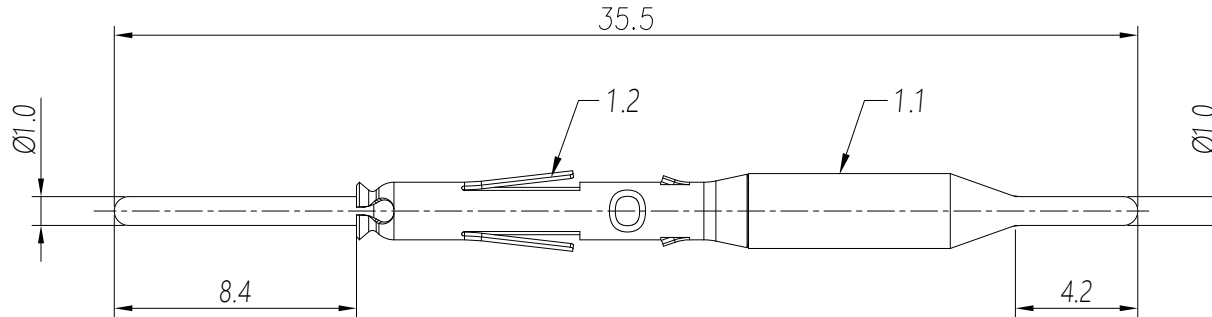

- NOTES: (UNLESS OTHERWISE SPECIFIED)
- MATERIAL:
 - CONTACT BODY: COPPER ALLOY.
 - OUTER SPRING: STAINLESS STEEL.
 - SPECIFICATIONS:
 - CURRENT RATING: 7.5A(MAX).
 - TERMINATION TYPE: SOLDER.
 - SUITABLE SOCKET TYPE: MS20W23xx.
 - ROHS COMPLIANT.
 - ALL DIMENSIONS ARE FOR REFERENCE USE ONLY.

P/N	CONTACT PLATING(MATING AREA)
MP20W12E06F	GOLD FLASH PLATING OVER NICKEL.
MP20W12E06G5	5μ" GOLD PLATING OVER NICKEL.
MP20W12E06G10	10μ" GOLD PLATING OVER NICKEL.
MP20W12E06G15	15μ" GOLD PLATING OVER NICKEL.
MP20W12E06G30	30μ" GOLD PLATING OVER NICKEL.

TITLE: ECO-MATE PIN CONTACT MACHINE 20# DIP TYPE
 DWG NO: MP20W12E06xx
 REV: B1
 SH: 1
 OF: 1

QUANTITY	PART NUMBER	DESCRIPTION	ITEM
MATERIALS LIST			
<small>UNLESS OTHERWISE SPECIFIED: 1) All dimensions are in metric(mm). 2) Tolerances are as follows: 1 PL DEC ±0.30 2 PL DEC ±0.15 3 PL DEC ±0.08 3) Note reference = </small>		<small>SIGNATURES</small> DRAWN: Arrow DATE: JULY-10-2015 CHECKED: ENGINEER: APPROVAL:	Amphenol Sine Systems - www.amphenol-sine.com 44724 Morley Drive Clinton Township, MI 48036
<small>MATERIAL SPECIFICATIONS:</small>		<small>CUSTOMER:</small>	ECO-MATE, PIN CONTACT, MACHINE, 20#, DIP TYPE.
<small>PROCESS SPECIFICATIONS:</small>		<small>THIS DRAWING IS SUPPLIED FOR INFORMATION ONLY. DESIGN FEATURES, SPECIFICATIONS AND PERFORMANCE DATA SHOWN HEREON ARE THE PROPERTY OF THE AMPHENOL CORPORATION. NO RIGHTS OF REPRODUCTION ARE IMPLIED. ALL DIMENSIONS ARE SUBJECT TO NORMAL MANUFACTURING VARIATIONS.</small>	<small>SIZE</small> B <small>TYPE</small> C- <small>DWG NO:</small> MP20W12E06xx <small>REVISION</small> B1
<small>NEXT ASSY:</small>		<small>SCALE</small> NONE	<small>SHEET</small> 1 <small>OF</small> 1