

REVISIONS					
REV	ECO	DESCRIPTION	DATE	BY	APPR
A1	-	RELEASE NEW DRAWING	13/NOV/23	VITO	TOMMY
A2	-	ADDED "BOARDLOCK" TO TITLE	15/JUL/24	JHEAD	BL
A3	-	UPDATE THE TORQUE	23/OCT/24	KELIN	TOMMY
A4	-	UPDATE THE KEY 07,08,09,10 FEATURE	28/MAR/25	KELIN	TOMMY

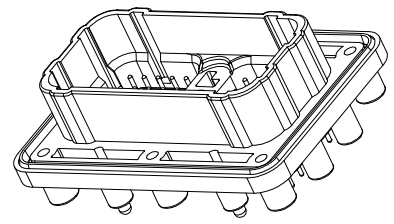
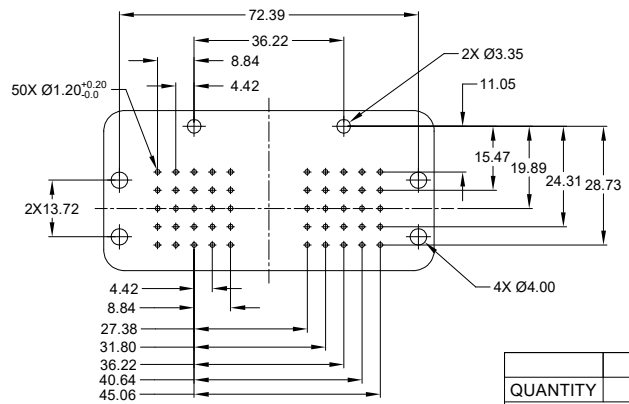
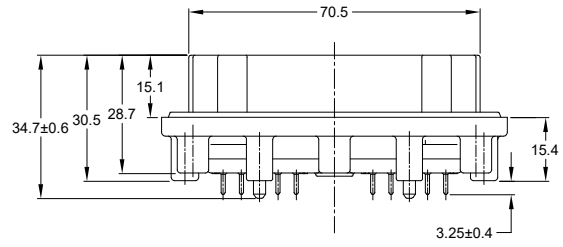
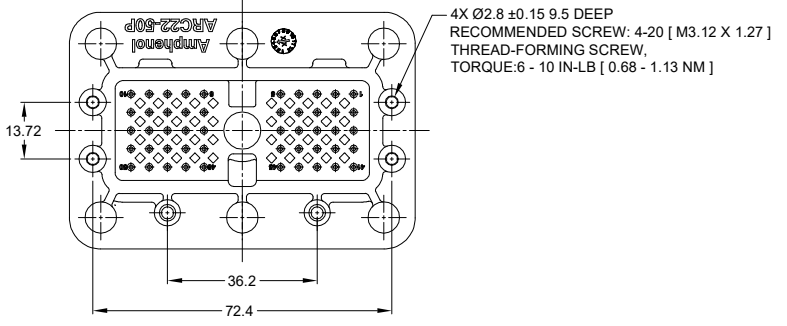
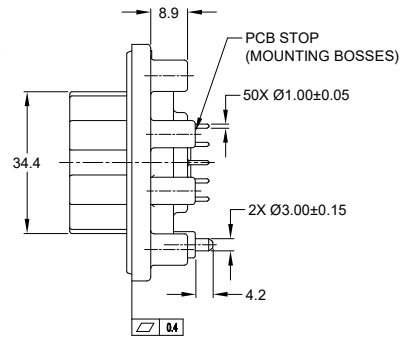
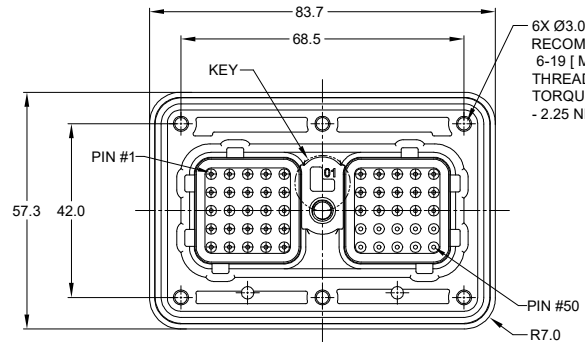

NOTES: UNLESS OTHERWISE SPECIFIED

- MATERIAL:
HOUSING: THERMOPLASTIC, BLACK
SEALS: SILICONE RUBBER, RED
THREADED INSERT: STAINLESS STEEL
CONTACT: COPPER ALLOY;
PLATING: ENGAGEMENT END GOLDPLATE, PCB END TIN PLATE
- MODIFICATIONS: PCB ,FLANGE STRAIGHT;
- SPECIFICATIONS:
3.1 CURRENT RATING: 7.5 AMPS MAX.
3.2 OPERATING TEMPERATURE: -55°C TO +125°C
3.3 DIELECTRIC WITHSTANDING VOLTAGE: LESS THAN 2 MILLIAMPS CURRENT LEAKAGE @ 1500 VOLTS AC
3.4 INSULATION RESISTANCE: 1000 MEGOHMS MIN @ 25°C
3.5 MOISTURE RESISTANCE:
IP68 (1M OF WATER FOR A PERIOD OF 24 HOURS, MATED CONDITION);
IP69K(MATED CONDITION)
3.6 MATING CYCLE DURABILITY: 100 CYCLES
3.7 RoHS COMPLIANT

- MATING PART: ARC26-50Sx* PLUG
(x = 01,02,03,...,10 KEYS ; * = ALL MODIFICATIONS)
- SEE SHEET 2 FOR OTHER KEY ARRANGEMENTS
- RECEPTACLE IS SHIPPED WITHOUT DUST CAP
- ALL DIMENSIONS ARE FOR REFERENCE USE ONLY

TOP VIEW OF PCB
ALL DIMENSIONS FOR REFERENCE ONLY

QUANTITY	SEE SHEET 2	DESCRIPTION	ITEM
	PART NUMBER		
MATERIALS LIST			
UNLESS OTHERWISE SPECIFIED 1) All dimensions are in metric (mm). 2) Tolerances are as follows: 1 PL DEC ±0.30 Fractions ±1/64 2 PL DEC ±0.15 Angles ±1° 3 PL DEC ±0.08 3) Note reference =		SIGNATURES DATE DRAWN: KELIN 27/MAR/25 CHECKED: SULLEN 28/MAR/25 ENGINEER: APPROVAL: TOMMY 28/MAR/25 CUSTOMER:	
MATERIAL SPECIFICATIONS: WEIGHT: 64.3g		 Sine Systems - www.amphenol-sine.com 44724 Morley Drive Clinton Township, MI 48036	
PROCESS SPECIFICATIONS:		THIS DRAWING IS SUPPLIED FOR INFORMATION ONLY. DESIGN FEATURES, SPECIFICATIONS AND PERFORMANCE DATA SHOWN HEREON ARE THE PROPERTY OF THE AMPHENOL CORPORATION. NO RIGHTS OF REPRODUCTION ARE IMPLIED. ALL DIMENSIONS ARE SUBJECT TO NORMAL MANUFACTURING VARIATIONS.	
NEXT ASSY:	SIZE: B	TYPE: C-	DWG NO: ARC22-50Px-BM01SP1 REVISION: A4
	SCALE: NONE	SHEET 1 OF 2	

TITLE: 50 POS,RECEPTACLE,PIN,ARC SERIES,BOARDLOCK,KEYED,BLK,SELECTIVE PLATED DWG NO: ARC22-50Px-BM01SP1 REV: A4 SH: 1 OF: 2

REVISIONS					
REV	ECO	DESCRIPTION	DATE	BY	APPR
A1	-	RELEASE NEW DRAWING	13/NOV/23	VITO	TOMMY
A2	-	ADDED "BOARDLOCK" TO TITLE	15/JUL/24	JHEAD	BL
A3	-	UPDATE THE TORQUE	23/OCT/24	KELIN	TOMMY
A4	-	UPDATE THE KEY 07,08,09,10 FEATURE	28/MAR/25	KELIN	TOMMY



ARC22-50Px-BM01SP1 VARIANTS	
PART NUMBER	REF
ARC22-50P01-BM01SP1	DRC22-50P01



ARC22-50Px-BM01SP1 VARIANTS	
PART NUMBER	REF
ARC22-50P03-BM01SP1	DRC22-50P03



ARC22-50Px-BM01SP1 VARIANTS	
PART NUMBER	REF
ARC22-50P05-BM01SP1	DRC22-50P05



ARC22-50Px-BM01SP1 VARIANTS	
PART NUMBER	REF
ARC22-50P07-BM01SP1	DRC22-50P07



ARC22-50Px-BM01SP1 VARIANTS	
PART NUMBER	REF
ARC22-50P09-BM01SP1	DRC22-50P09



ARC22-50Px-BM01SP1 VARIANTS	
PART NUMBER	REF
ARC22-50P02-BM01SP1	DRC22-50P02



ARC22-50Px-BM01SP1 VARIANTS	
PART NUMBER	REF
ARC22-50P04-BM01SP1	DRC22-50P04



ARC22-50Px-BM01SP1 VARIANTS	
PART NUMBER	REF
ARC22-50P06-BM01SP1	DRC22-50P06



ARC22-50Px-BM01SP1 VARIANTS	
PART NUMBER	REF
ARC22-50P08-BM01SP1	DRC22-50P08

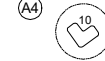

ARC22-50Px-BM01SP1 VARIANTS	
PART NUMBER	REF
ARC22-50P10-BM01SP1	DRC22-50P10

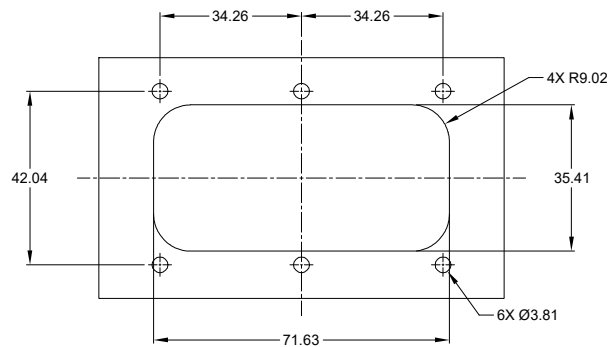

RECOMMENDED PANEL CUT OUT

-FOR REFERENCE ONLY-
SURFACE FINISH TO BE OR BETTER

ARC22-50Px-BM01SP1		DESCRIPTION		ITEM
QUANTITY	PART NUMBER	DESCRIPTION		ITEM
MATERIALS LIST				
UNLESS OTHERWISE SPECIFIED 1) All dimensions are in metric(mm). 2) Tolerances are as follows: 1 PL DEC ±0.30 Fractions ±1/64 2 PL DEC ±0.15 Angles ±1° 3 PL DEC ±0.08 3) Note reference =		SIGNATURES DATE DRAWN: KELIN 27/MAR/25 CHECKED: SULLEN 28/MAR/25 ENGINEER: APPROVAL: TOMMY 28/MAR/25 CUSTOMER: THIS DRAWING IS SUPPLIED FOR INFORMATION ONLY. DESIGN FEATURES, SPECIFICATIONS AND PERFORMANCE DATA SHOWN HEREON ARE THE PROPERTY OF THE AMPHENOL CORPORATION. NO RIGHTS OF REPRODUCTION ARE IMPLIED. ALL DIMENSIONS ARE SUBJECT TO NORMAL MANUFACTURING VARIATIONS.		
MATERIAL SPECIFICATIONS: WEIGHT: 643g		Amphenol Sine Systems - www.amphenol-sine.com 44724 Morley Drive Clinton Township, MI 48036 50 POS,RECEPTACLE,PIN,ARC SERIES W/ BOARDLOCK,KEYED,BLK,SELECTIVE PLATED		
PROCESS SPECIFICATIONS:		SCALE: B C- DWG NO: ARC22-50Px-BM01SP1 REVISION A4 SHEET 2 OF 2		
NEXT ASSY:				

TITLE: 50 POS,RECEPTACLE,PIN,ARC SERIES,BOARDLOCK,KEYED,BLK,SELECTIVE PLATED
 DWG NO: ARC22-50Px-BM01SP1
 REV: A4
 SH: 2
 OF: 2