

# DuraLok™ ATV 38 Position

## Assembly and Disassembly Instructions for DuraLok™ ATV 38 Position

The following Instructions refer to the steps needed for proper contact insertion/extraction when using our DuraLok ATV 38POS plugs and receptacles.

### Required Tooling

Part Number	Description
ATRT-100	Contact and Wedgelock Extraction Tool
QXRT16	Extraction Tool for #16 Contact
ATV38-RT01-PIN	Extraction Tool for #16 Contact
ATV38-RT02-SOC	Extraction Tool for #16 Contact

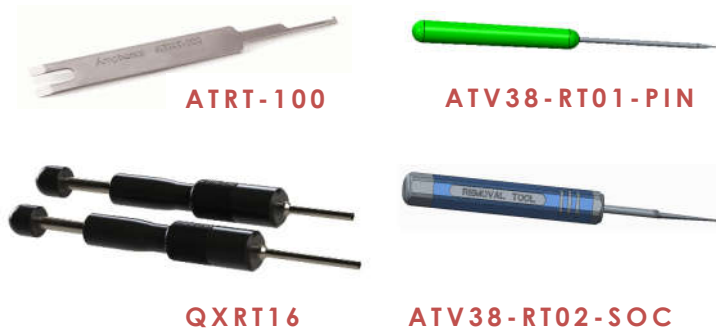

### DuraLok ATV Receptacle: Contact Insertion

#### Step 1

Crimp pin contacts(SC000571X) to wire. See appropriate datasheets for application tool.

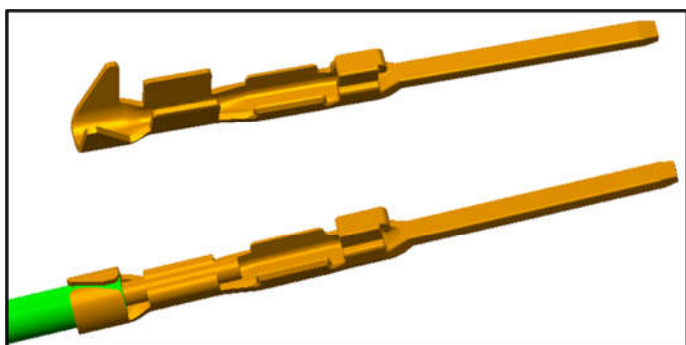

#### Step 2

Insert crimped contact through rear seal of receptacle.

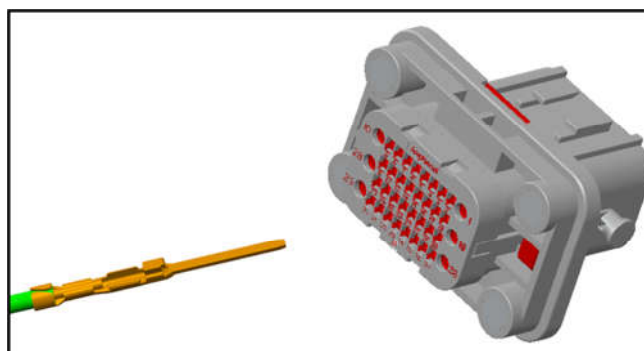

#### Step 3

Push contact straight into connector until a positive stop is felt. A slight tug will confirm that it is properly locked in position.

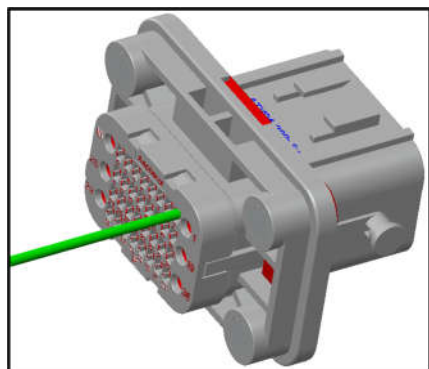

#### Step 4

Section View showing final position of contact for reference.

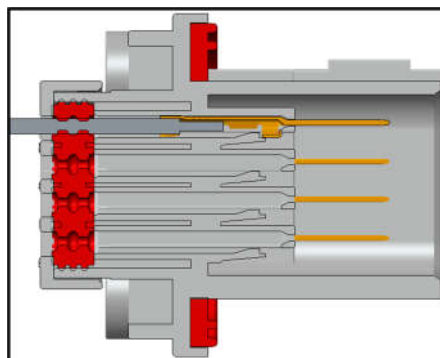

## DuraLok ATV Receptacle: Contact Insertion

### Step 5

Crimp pin contacts (SPXXM1X) to wire. See appropriate datasheets for application tool.

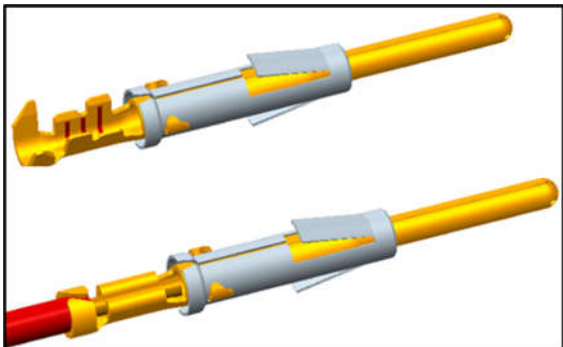

### Step 6

Insert crimped contact through rear seal of receptacle.

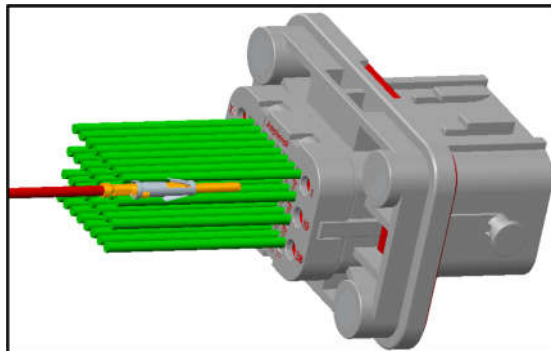

### Step 7

Push contact straight into connector until a positive stop is felt. A slight tug will confirm that it is properly locked in position.

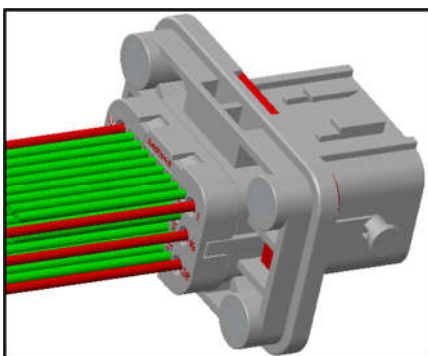

### Step 8

Section View showing final position of contact for reference.

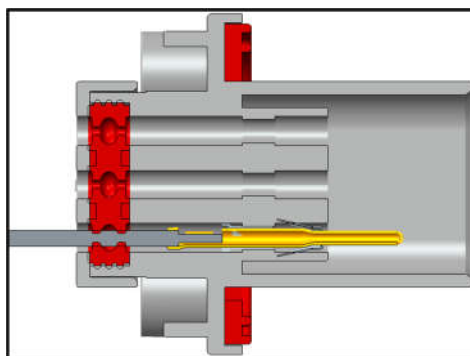

### Step 9

Push the wedge vertically into receptacle after the wedge align to the Hole of the receptacle.

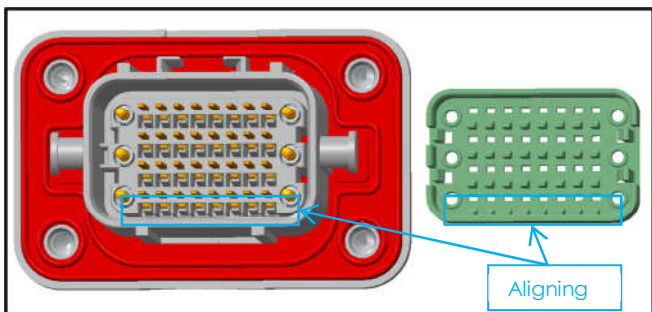

### Step 10

Assemble wedge into the connector.

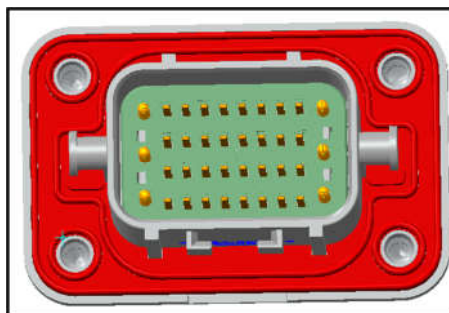

## DuraLok ATV Receptacle: Contact Extraction

### Step 1

Use the small end of the AT Extraction Tool(ATRT-100) to pry open the 2 side clasps and remove the Location Block.

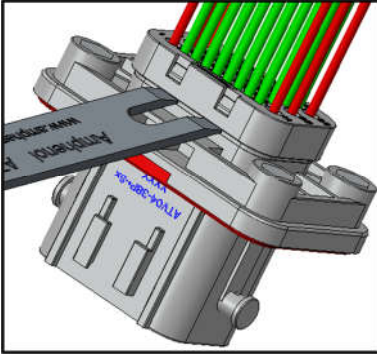

### Step 2

Prize up removal tool until cover and wire seal out of connector.

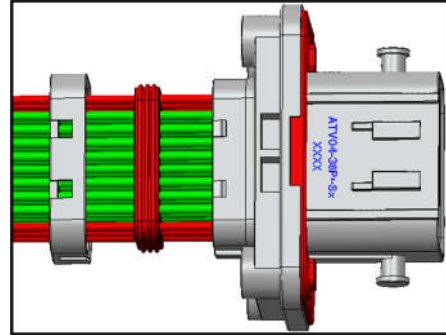

### Step 3

Use one end of the workpiece to extend the clamp of the pressure plate.

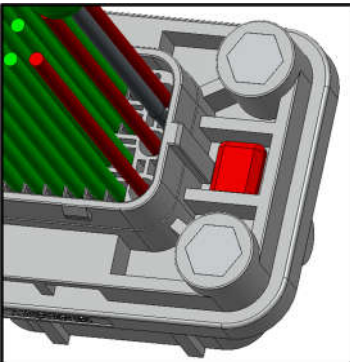

### Step 4

Wrap the contact with the tool (ATV38-RT01-PIN)and push the cover out of the receptacle.

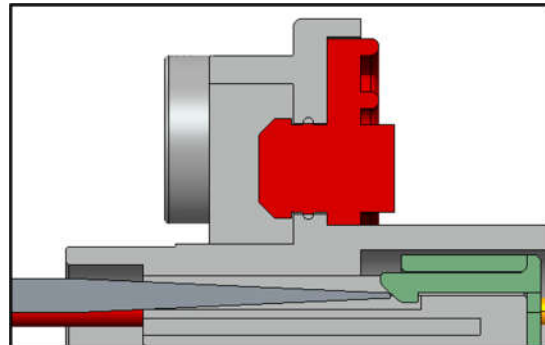

### Step 5

The wedge out the connector.

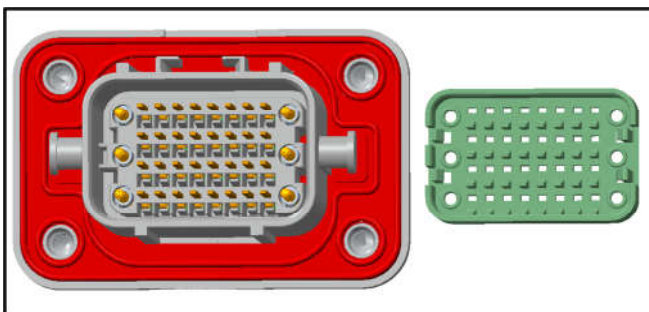

## DuraLok ATV Receptacle: Contact Extraction

### Step 6

Use a removal tool(QXRT16) to press the SPXXM1X contacts spring and remove it.

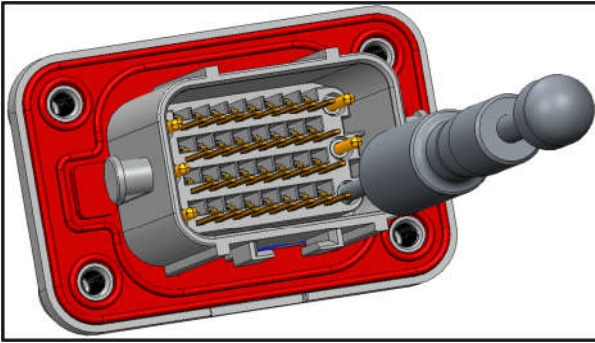

### Step 7

Sectional view of tool and terminal matching for pick-up.

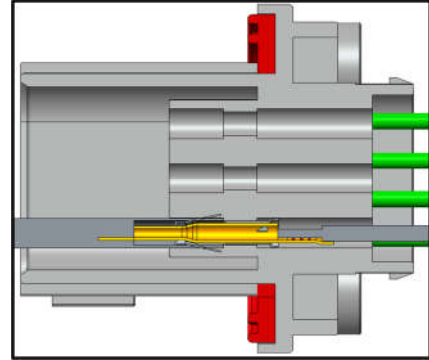

### Step 8

Use a removal tool(ATV38-RT02-SOC) to open the plastic buckle and remove the SC000571X contacts.

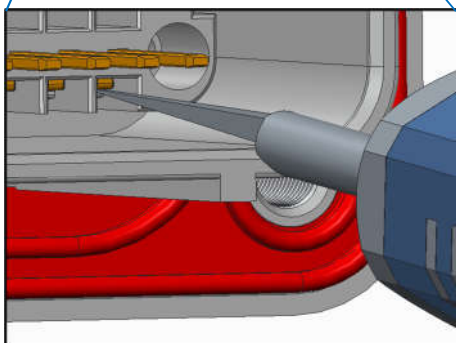
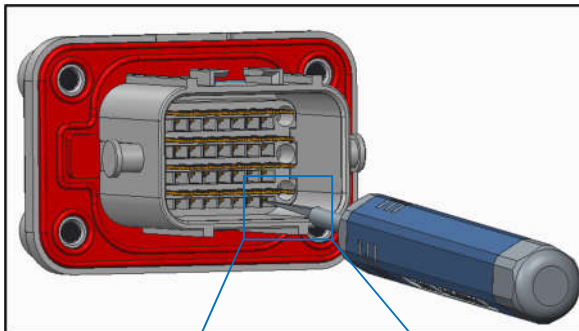

### Step 9

Sectional view of tool and terminal matching for pick-up.

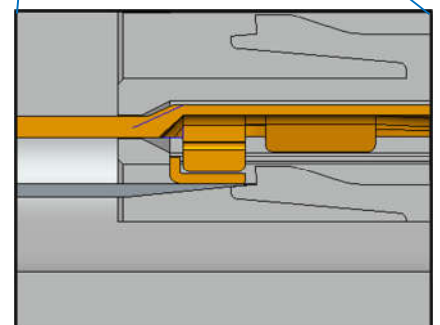
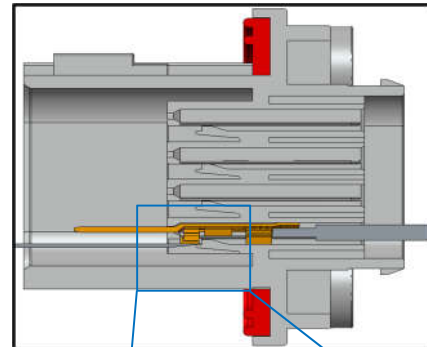

## DuraLok ATV Plug: Contact Extraction

### Step 1

Crimp socket contacts(SC000572X) to wire. See appropriate datasheets for application tool.

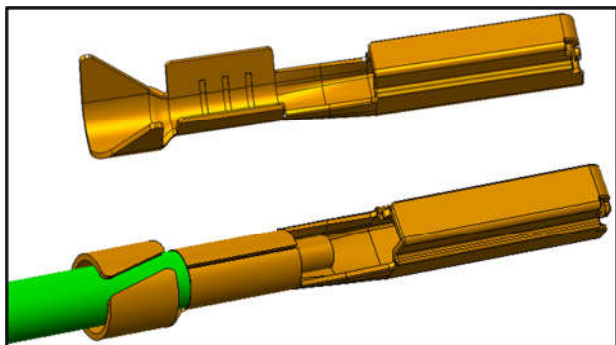

### Step 2

Insert crimped contact through rear seal of plug.



### Step 3

Push contact straight into connector until a positive stop is felt. A slight tug will confirm that it is properly locked in position.

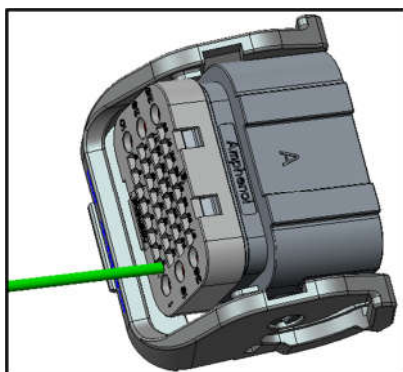

### Step 4

Section View showing final position of contact for reference.

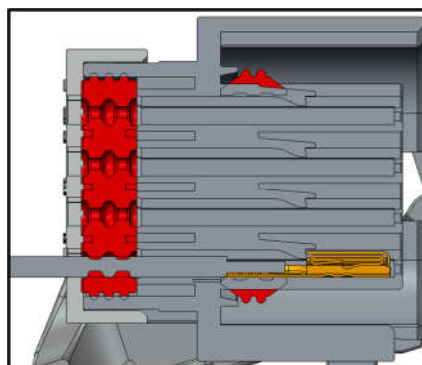

**DuraLok ATV Plug: Contact Extraction**

**Step 5**

Crimp socket contacts(SSXXM1X) to wire. See appropriate datasheets for application tool.

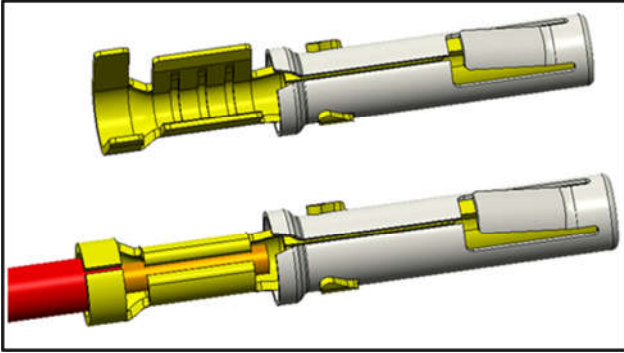

**Step 6**

Insert crimped contact through rear seal of plug.

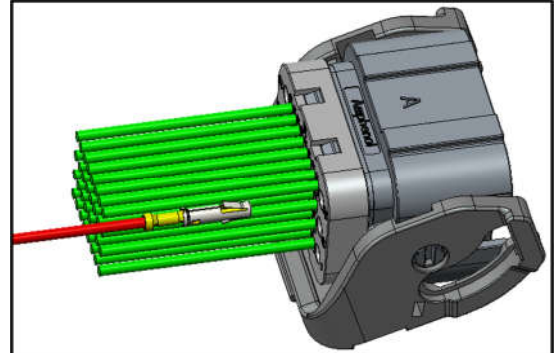

**Step 7**

Push contact straight into connector until a positive stop is felt. A slight tug will confirm that it is properly locked in position.

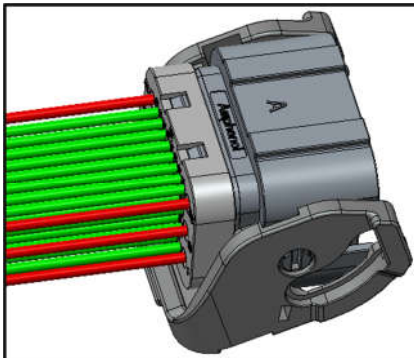

**Step 8**

Section View showing final position of contact for reference.

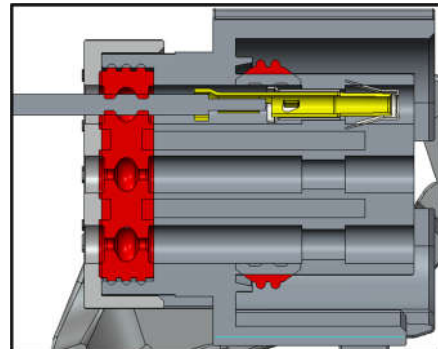

**Step 9**

Push the wedge vertically into plug after the wedge align to the Hole of the plug.

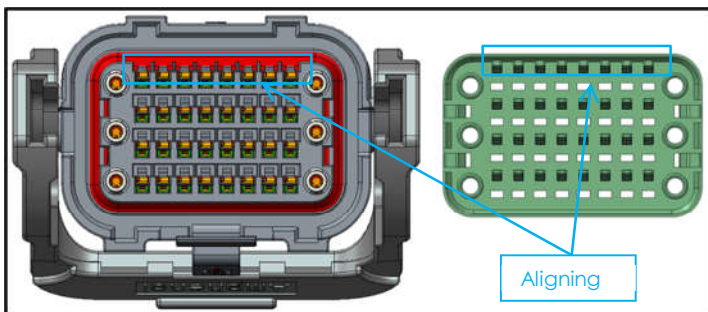

**Step 10**

Assemble wedge into the connector.



## DuraLok ATV Plug: Contact Extraction

### Step 1

Use the small end of the AT Extraction Tool(ATRT-100) to pry open the 2 side clasps and remove the Location Block.

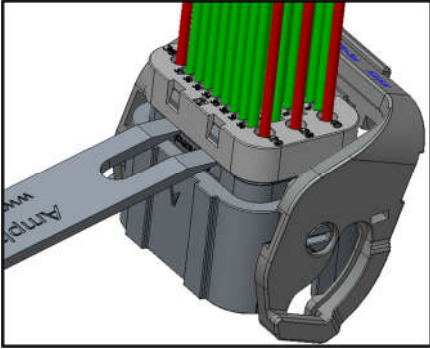

### Step 2

Prize up removal tool until cover and wire seal out of connector.

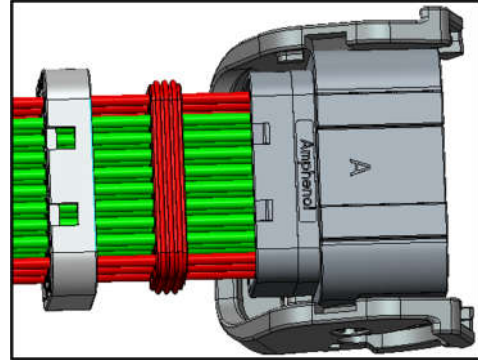

### Step 3

Use one end of the AT Extraction Tool(ATRT-100) to extend the clamp of the pressure plate.

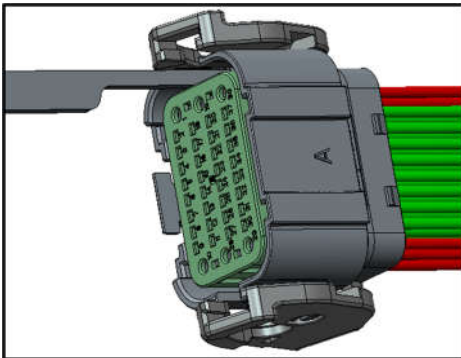

### Step 4

Wrap the contact with the tool and push the cover out of the plug.

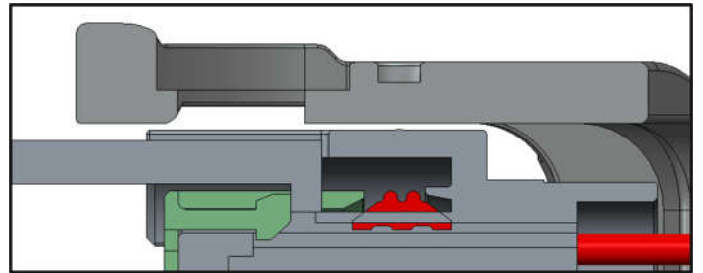

### Step 5

The wedge out the connector.

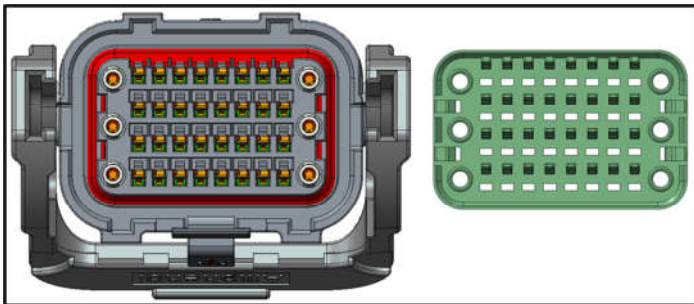

## DuraLok ATV Plug: Contact Extraction

### Step 6

Use a removal tool(QXRT16) to press the SSXXM1X contacts spring and remove it.

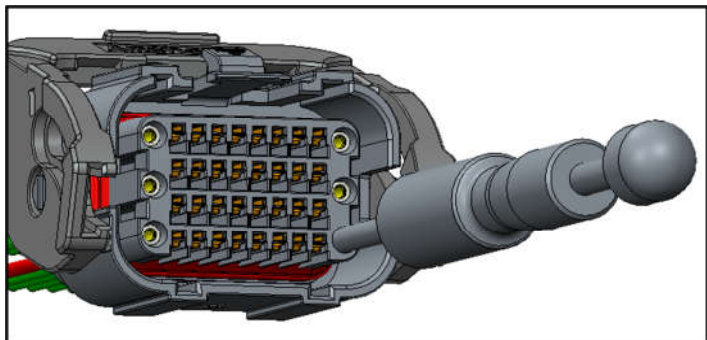

### Step 7

Sectional view of tool and terminal matching for pick-up.

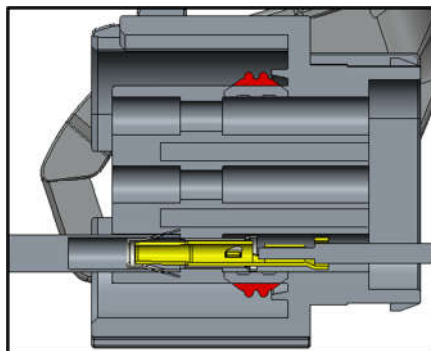

### Step 8

Use a removal tool(ATV38-RT02-SOC) to open the plastic buckle and remove the SC000572X contacts.

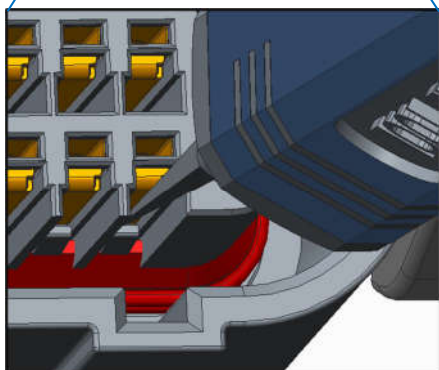
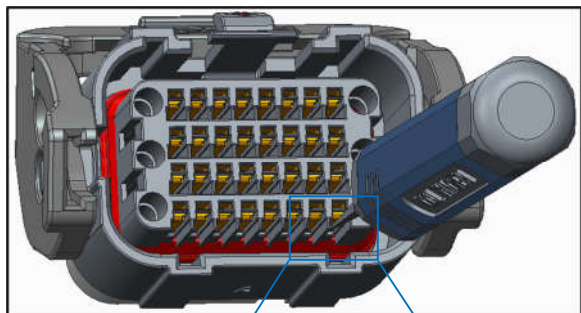

### Step 9

Sectional view of tool and terminal matching for pick-up.

